

Hor met rem in zijgeleiders

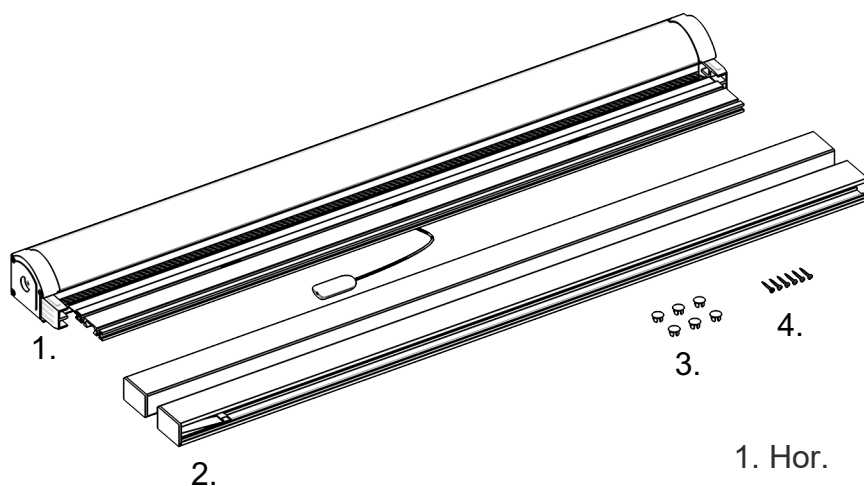

1. Hor.
2. Zeigeleiders.

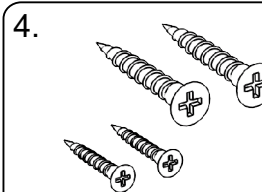
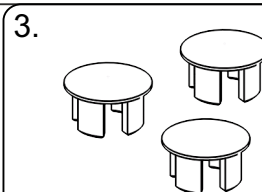

3. Afdek kapjes.
4. Schroeven

Hor met lock bar

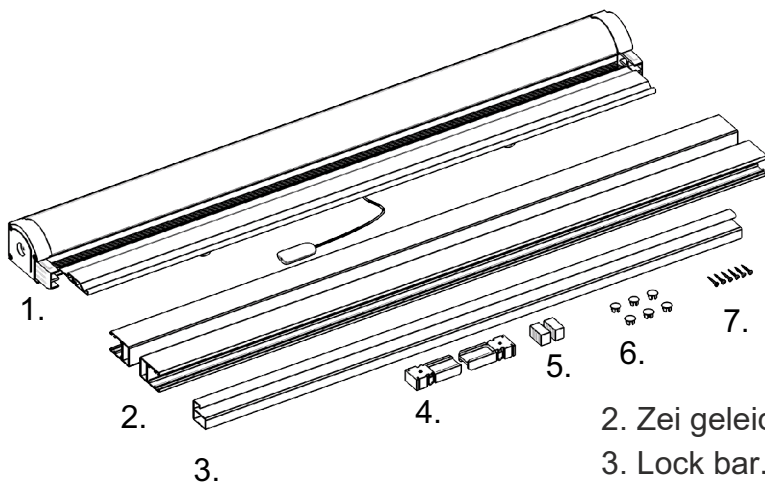

1. Hor.

2. Zei geleiders.
3. Lock bar.
4. Zei geleider koppelingen.

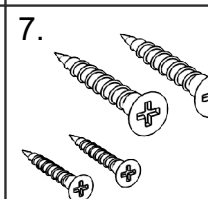
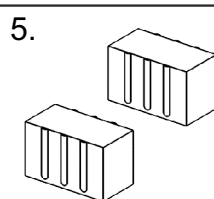
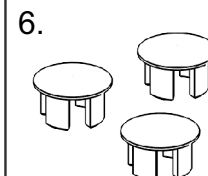
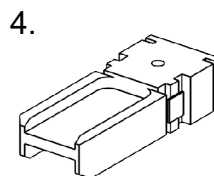

5. Onder kapjes.
6. Afdekplaatjes.
7. Schroeven.

Fig. 1 Cassette

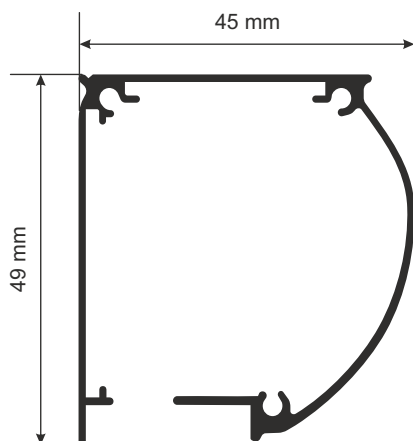

Fig. 2 Zeigeleiders.

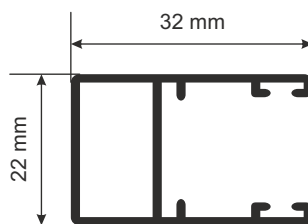
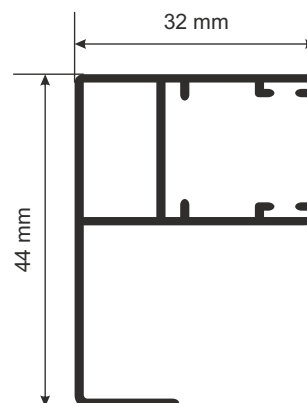
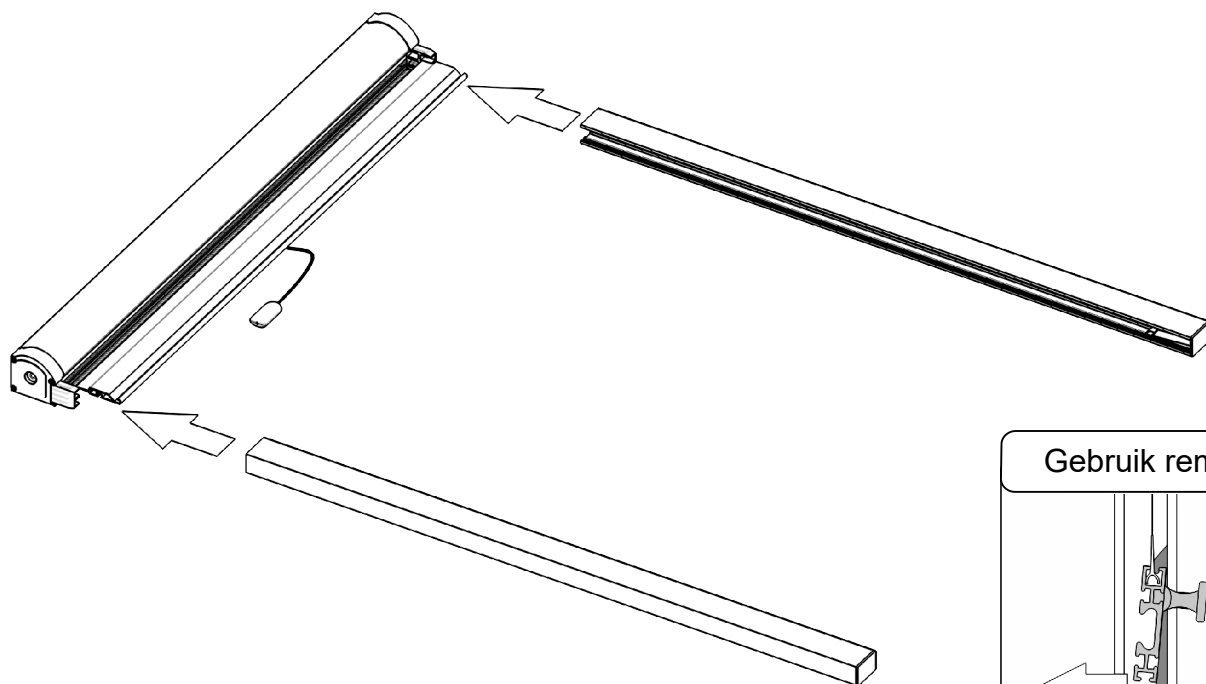

Fig. 3 Verhoogde zijgeleiders.



Montage hor met rem systeem



Gebruik rem.

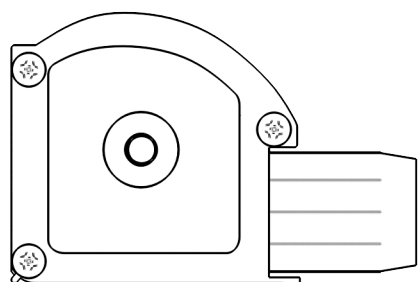
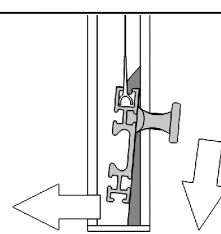

Gat boren



Ø 1.8 mm

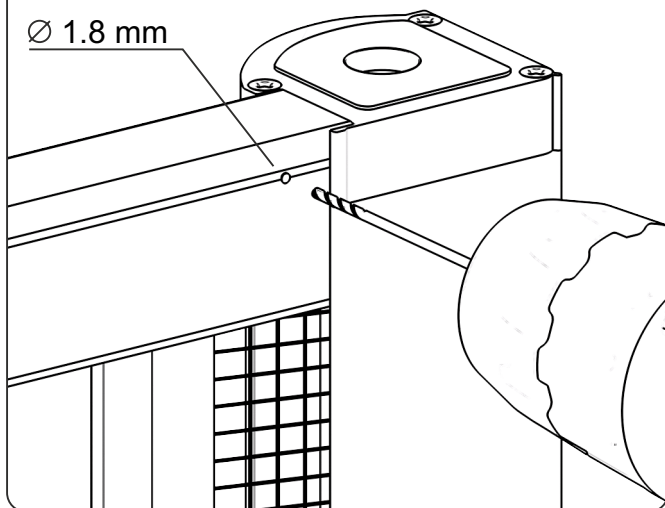

Vastzetten hor

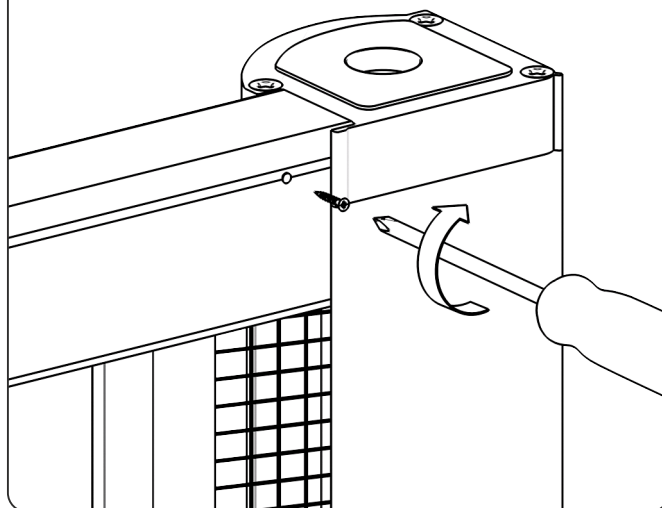

Rolhor vastzetten

Diameters:

Afdekplaatje $\varnothing 8$ mm

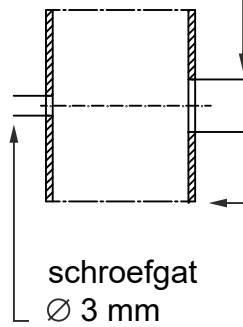

schroefgat
 $\varnothing 3$ mm

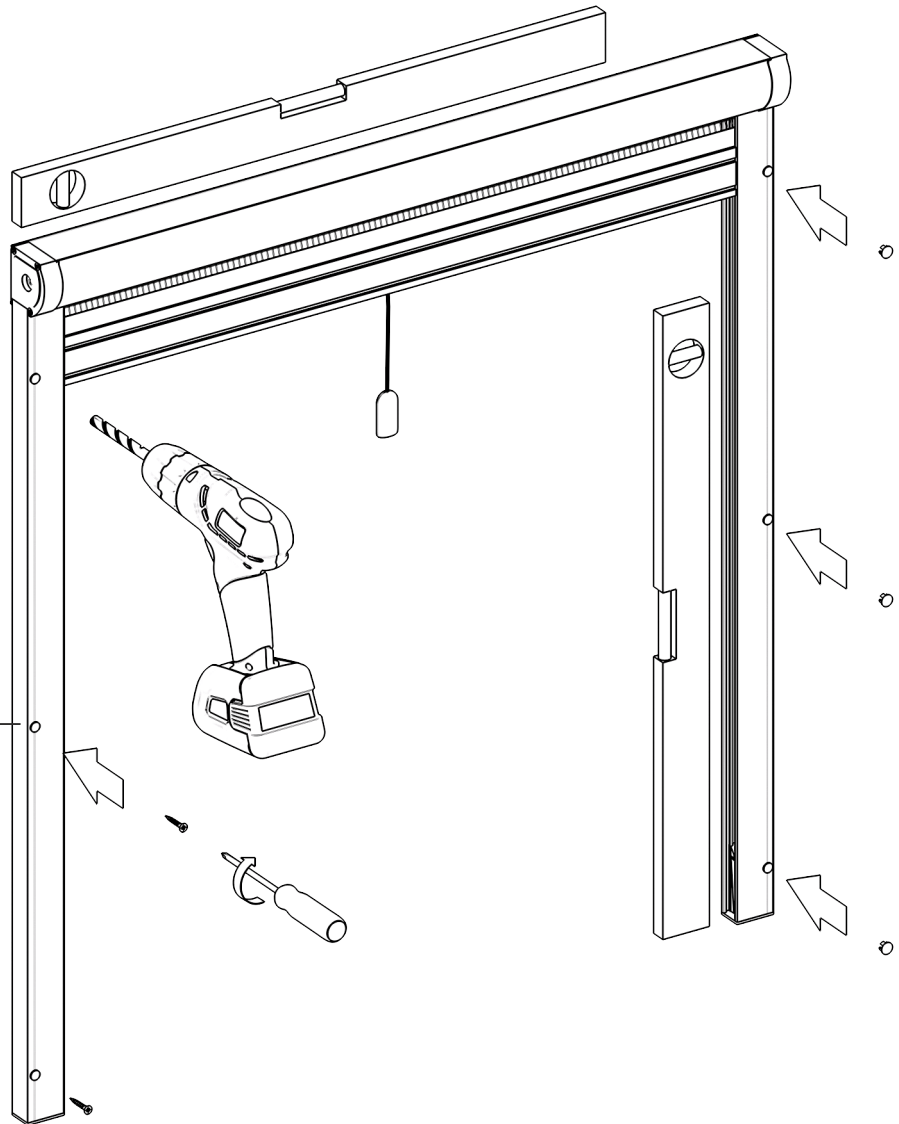

Hor vastzetten

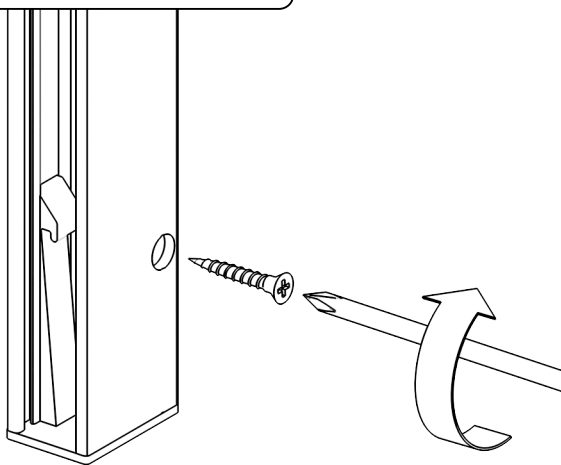

Afdekplaatjes monteren

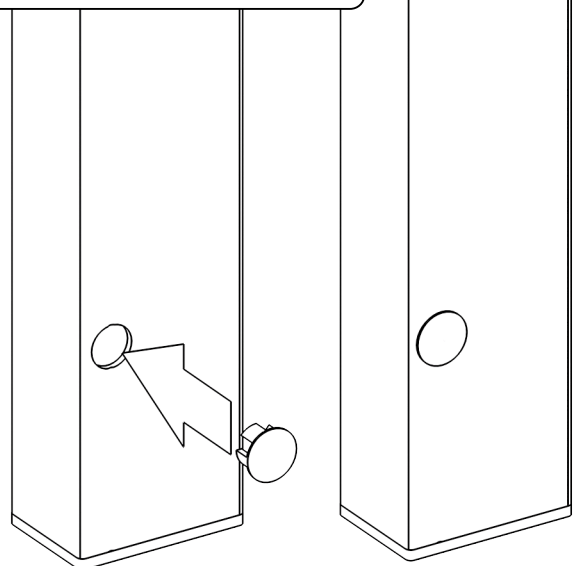

Monteren rolhor met lock bar.

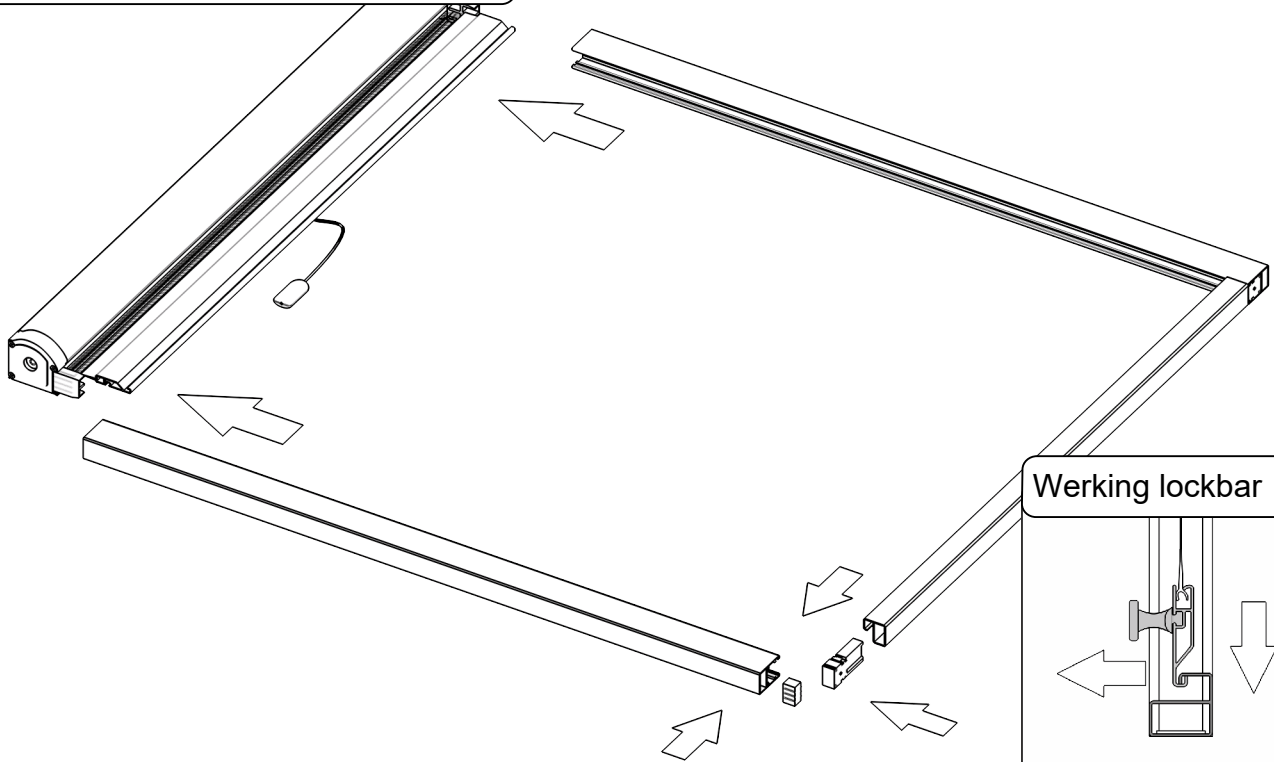

Gat boren

Ø 1.8 mm

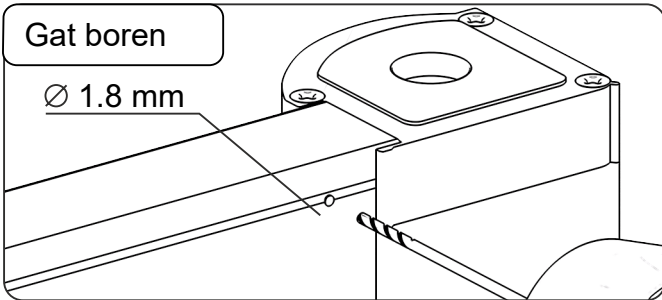

Koppelen cassette en zijgeleider

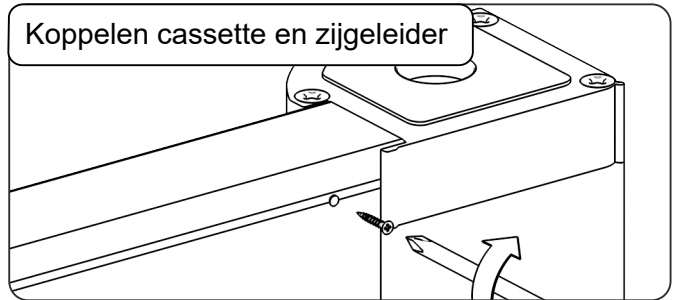

Monteren zijgeleiders met koppelstukken

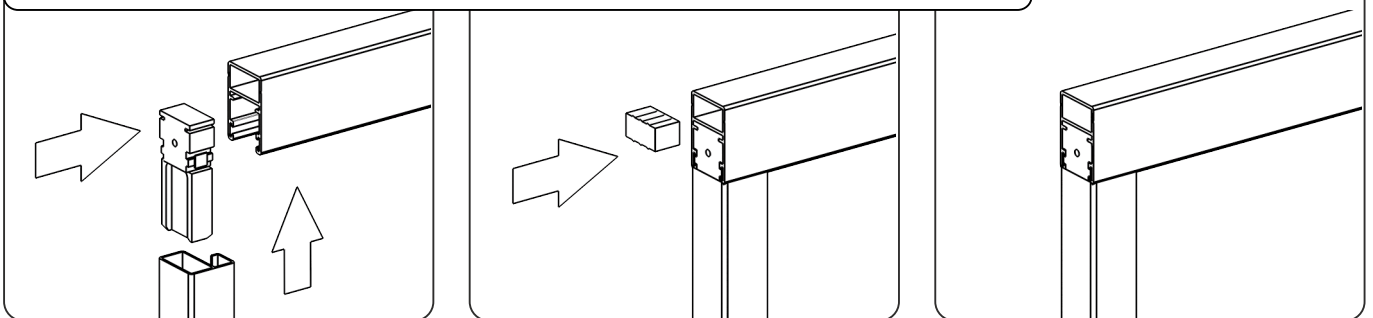

Gat boren

Ø 1.8 mm

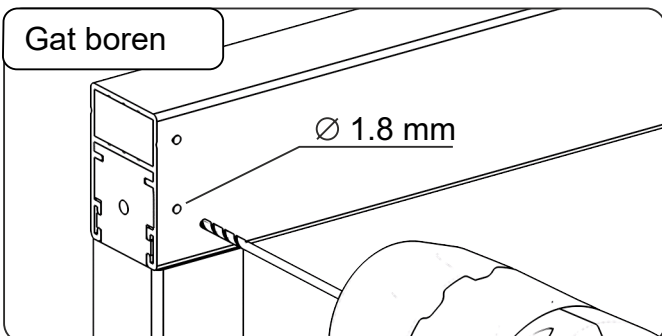

Vastzetten zijgeleiders

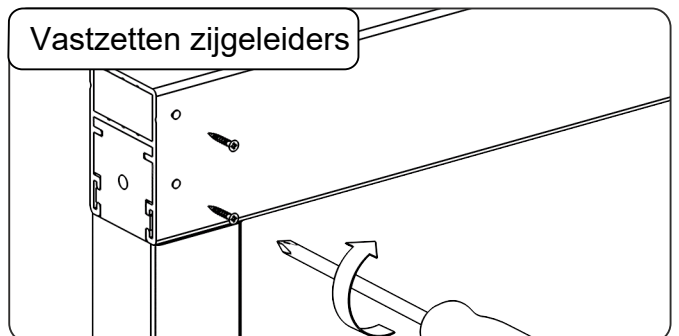

Monteren rolhor

Afdekplaatje
diameter \varnothing 8 mm

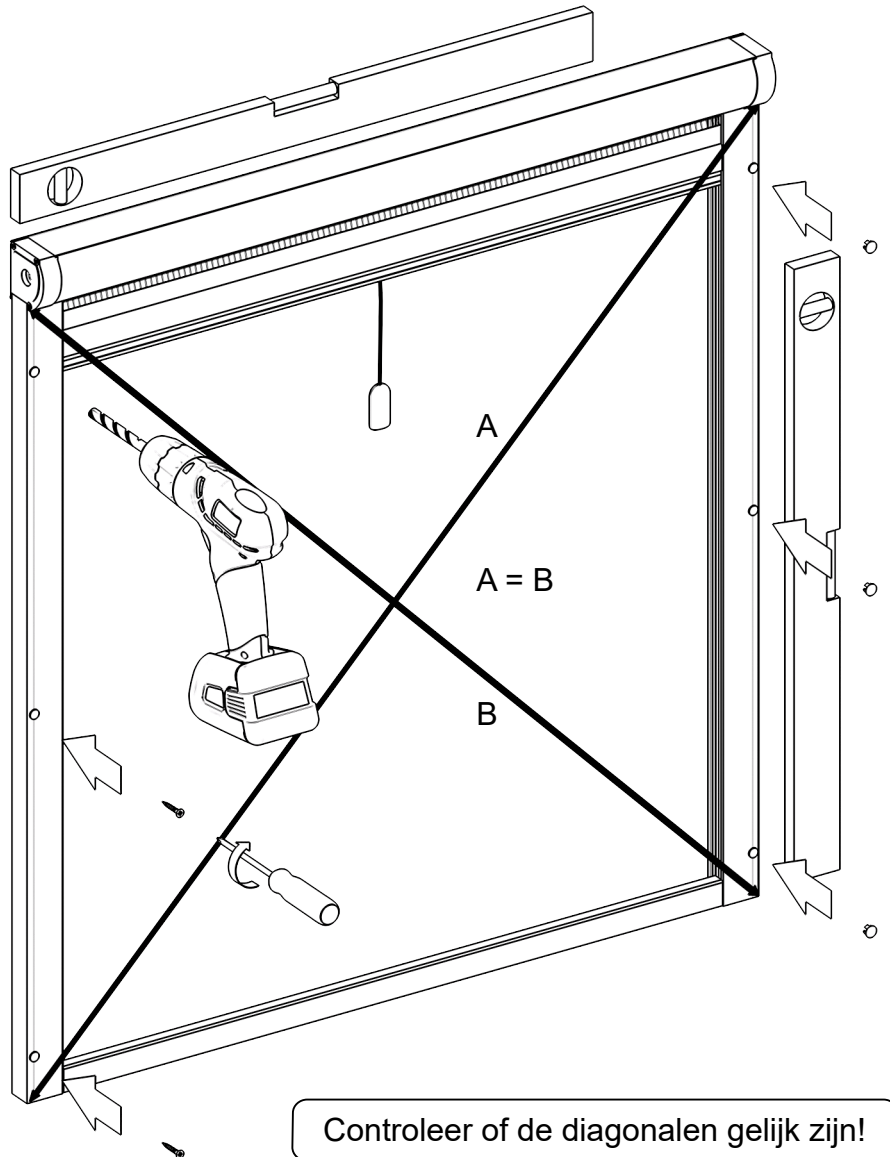
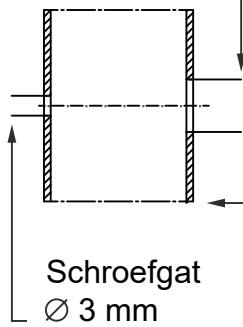

Controleer of de diagonalen gelijk zijn!

Hor vastzetten

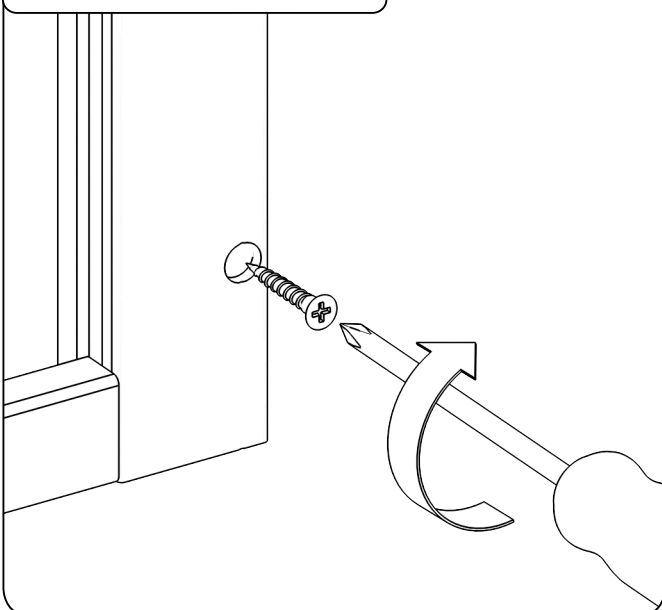

Afdek plaatjes plaatsen

